

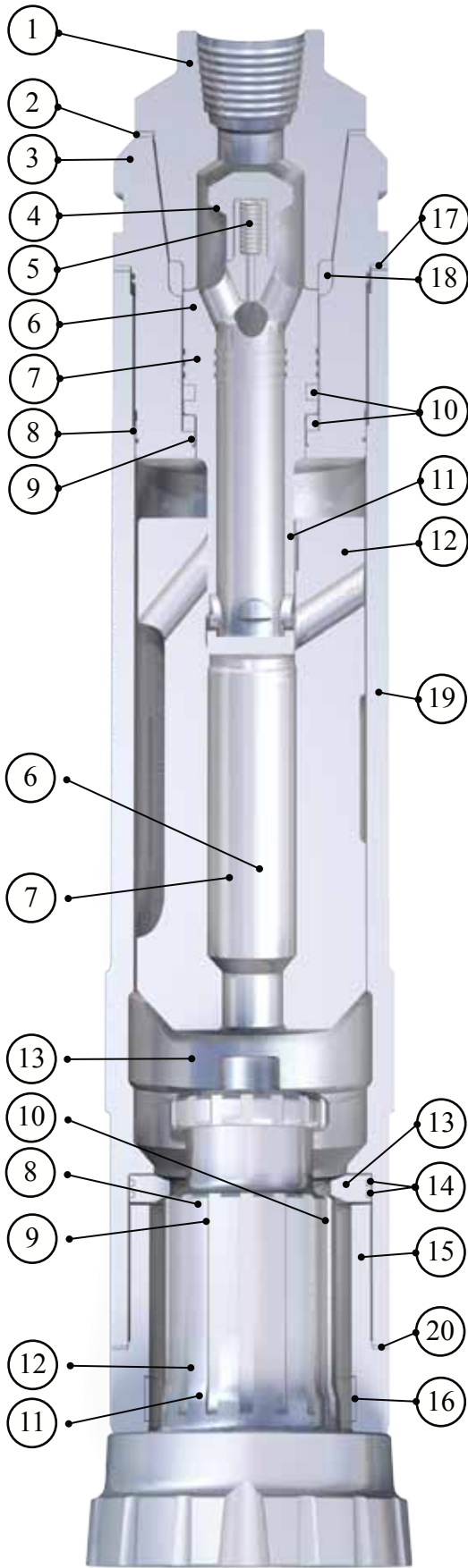

**Hyper 241
D.T.H Hammer**



Hyper 241 Valveless Hammer

610mm (24") - 864mm (34") dia. Holes

The Bulroc Hyper 241 hammer is a valveless DTH hammer designed to operate efficiently at pressures ranging from 7 bar to 12 bar (100psi - 175psi). The hammer is supplied with an 8 $\frac{5}{8}$ " pin backhead as standard an 8 $\frac{3}{4}$ " can be supplied. A positive seating check valve is fitted. The Hyper 241 is supplied to suit the N240 shank as standard.

Component Parts

Ref	Description	Part Number	Qty
1	Backhead Adaptor 85/8" Reg. Box	HSH24138AD082F	1
2	Backhead Adaptor Breakout washer	HSH24127	1
3	Backhead	HSH24138	1
4	Check Valve	HSH24108	1
5	Check Valve Spring	HSH24110	1
6	Valve Chest	HSH24104	1
7	Compression Buffer	HSH24128	1
8	Backhead 'O' Ring	HSH241114B	1
9	Internal Backhead 'O' Ring	HSH2411514	1
10	Tube Buffers (2)	HSH24129	1
11	Control Tube	HSH24130	1
12	Piston	HSH24103240	1
13	Bit Retaining Ring	HSH24137240	1
14	Bit Retainer 'O' Ring (2)	HSH24137A240	1
15	Chuck	HSH24135240	1
16	Chuck Bearing	HSH24135240BE	1
17	Breakout Washer Backhead	HSH24125	1
18	Internal Washer Adaptor	HSH24106	1
19	Wearsleeve	HSH24100	1
20	Breakout Washer Chuck	HSH24126	1
	Complete Hammer	BR241H01	

Hammer Specification

	Imperial	Metric
Weight (less bit)	5522 lbs	2510 Kg
Length (less bit)	92.7"	2355 mm
Outside dia.	21"	533 mm
Bore dia.	17.02"	433 mm
Piston weight	1400 lbs	630 Kg
Stroke	6.00"	152mm

Air Consumption

PSI	BAR	C.F.M	Cu. Mtr / min
100	6.90	2188	61.90
125	8.60	3059	86.60
150	10.34	4020	113.80
175	12.07	5066	143.40
200	13.80	6191	209.10